

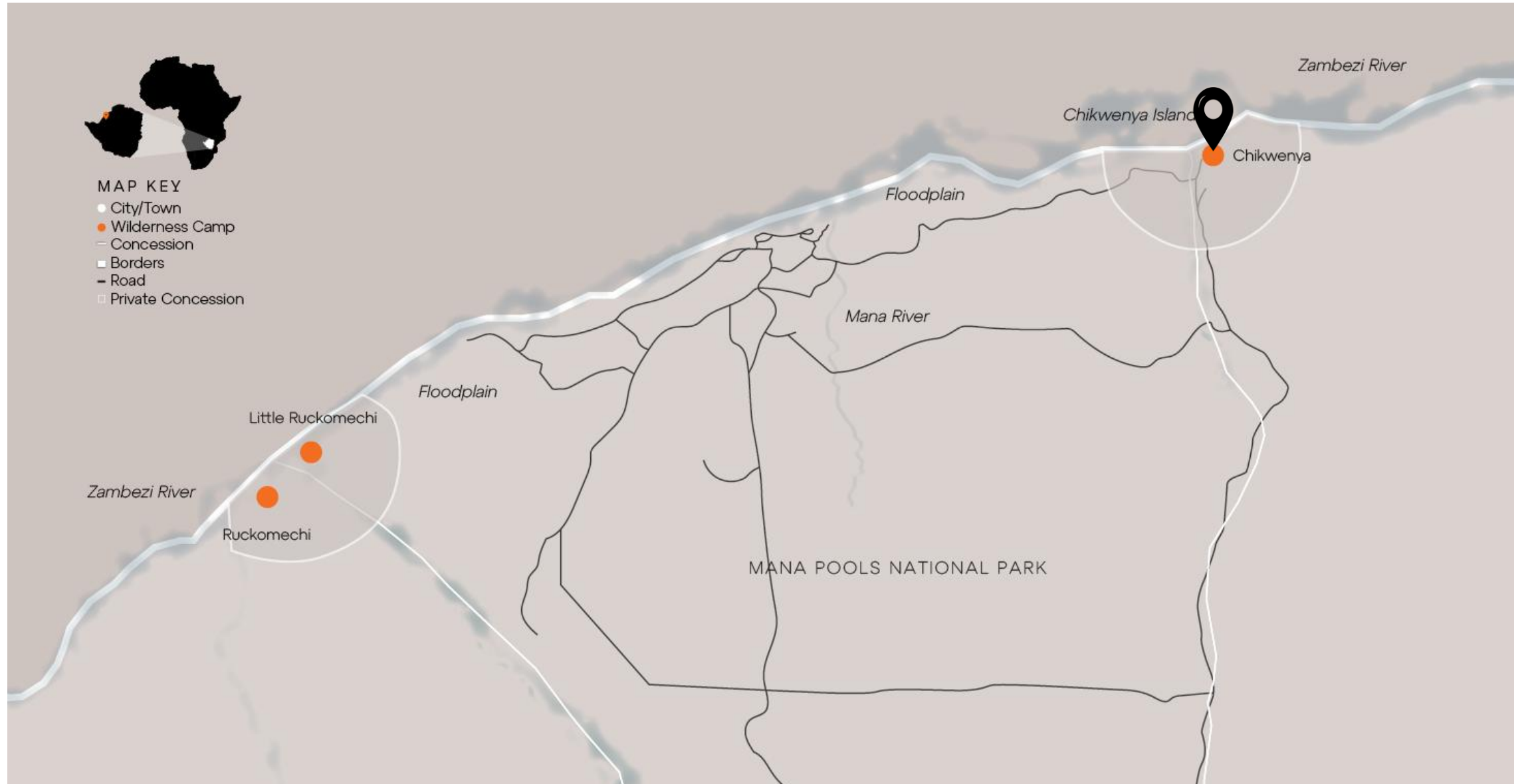

WILDERNESS

CHIKWENYA



UNIQUE SELLING POINTS

Chikwenya

- Located at the confluence of the Sapi and Zambezi rivers in an exclusive, private wilderness area on Mana Pools' eastern boundary, the exceptionally photogenic Wilderness Chikwenya epitomises the national park's UNESCO World Heritage status, earned through the purity of its wilderness, beauty and wildlife sightings.
- The area is a compact concentration of scenic habitats (woodlands, floodplains, pans, islands and two iconic rivers) teeming with thrilling and diverse wildlife.
- Particularly noted for its walking safaris, Wilderness Chikwenya offers a range of other exciting adventures: on land – walking, day and night game drives; on the river – boating, catch-and-release fishing; and sensational picnics on Chikwenya Island in the river.



About Chikwenya



7 tents
(2 family)



Combination
System



Canoeing



Catch-and-
release fishing



Game drives
(day and
night)



Guided nature
walks



Boating

Access to Chikwenya

- Airstrip name: Chikwenya Airstrip
- Duration to camp: An approximately 10-minute vehicle transfer

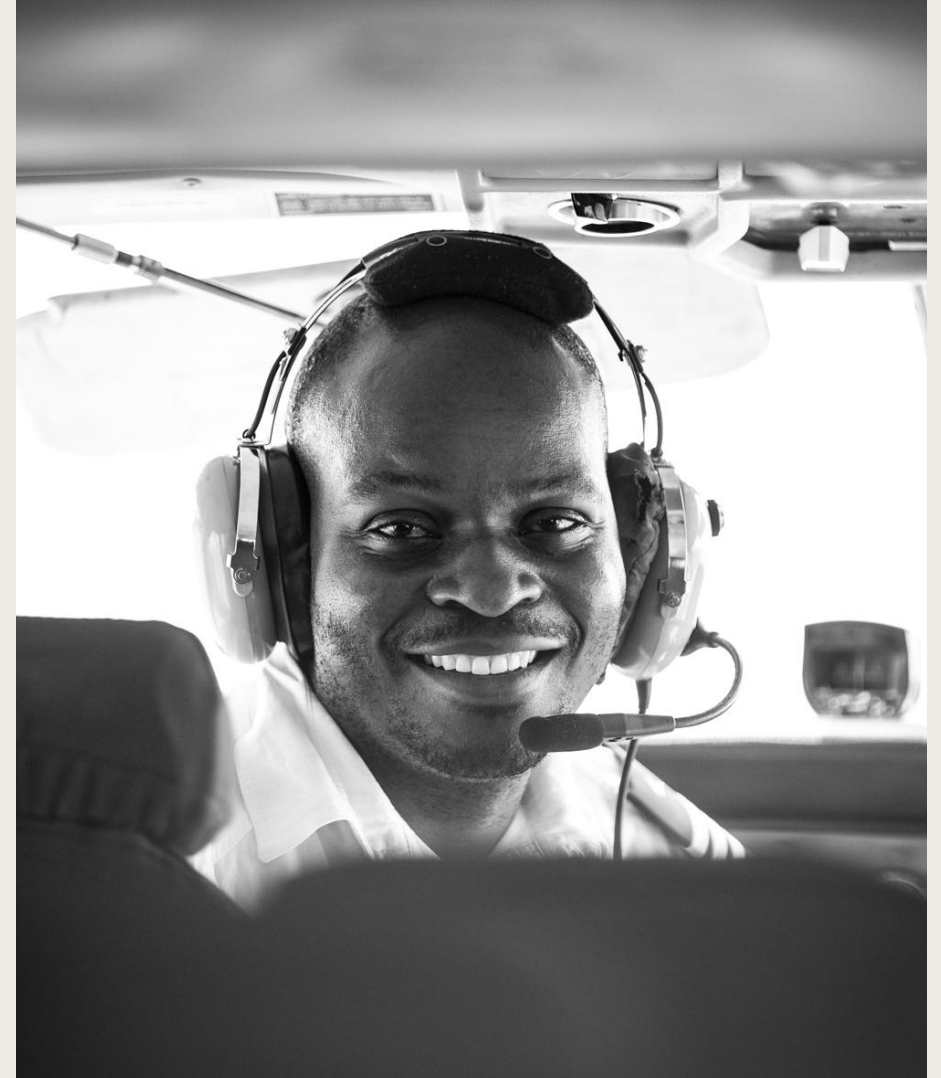



CHIKWENYA PURPOSE

Sacred Chikwenya

As a private-access area neighbouring Mana Pools National Park, Wilderness Chikwenya plays an important role in protecting what is considered one of the great wildlife spectacles on the continent, as well as in preserving a feel of real wilderness – a function that is recognised through its World Heritage Site status.

ACCOMMODATION

Chikwenya

- With its exceptionally beautiful location on floodplains that sweep down to the broad Zambezi, and views of the dazzling Rift Valley mountains beyond, Chikwenya is noted for exceptional sightings from ‘your armchair’ in camp – not only for the ever-present elephants and diverse bird species, but many plains game seen passing through – sometimes even followed by predators.
- Tranquil and exquisite, Chikwenya’s seven elegant rooms (including two family units) are situated amongst shady albida trees – much loved by elephants, often seen feeding on tiptoe – and glorious Natal mahoganies.



SUITE

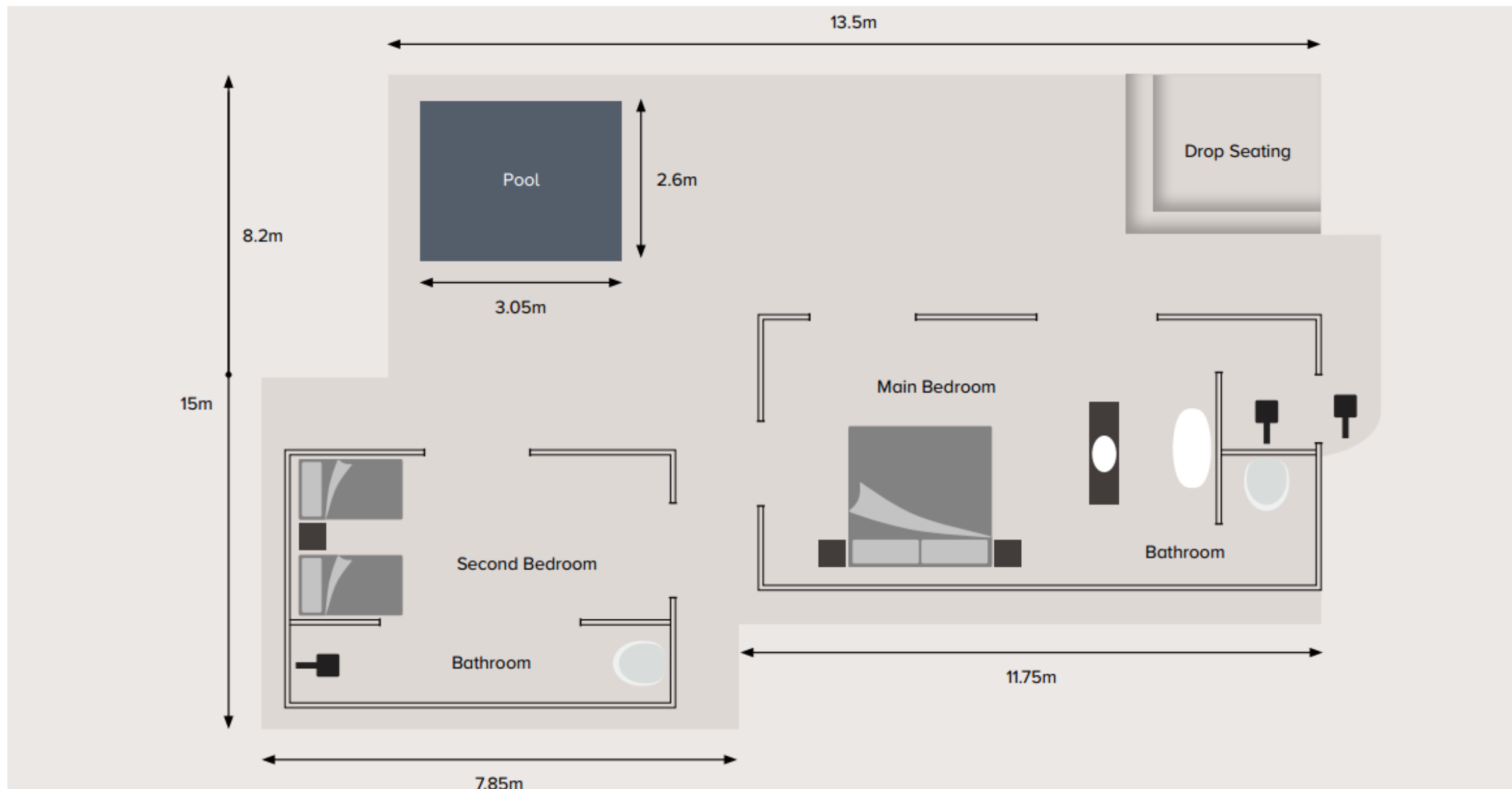



Catering was outstanding & special attention was given to dietary requirements. Excellent food & service. Cosmo was an outstanding guide - knowledgeable, personable and went the extra mile to make our experience enjoyable. Thank you to all the staff at Chikwenya for a memorable few days.

Chikwenya Guest









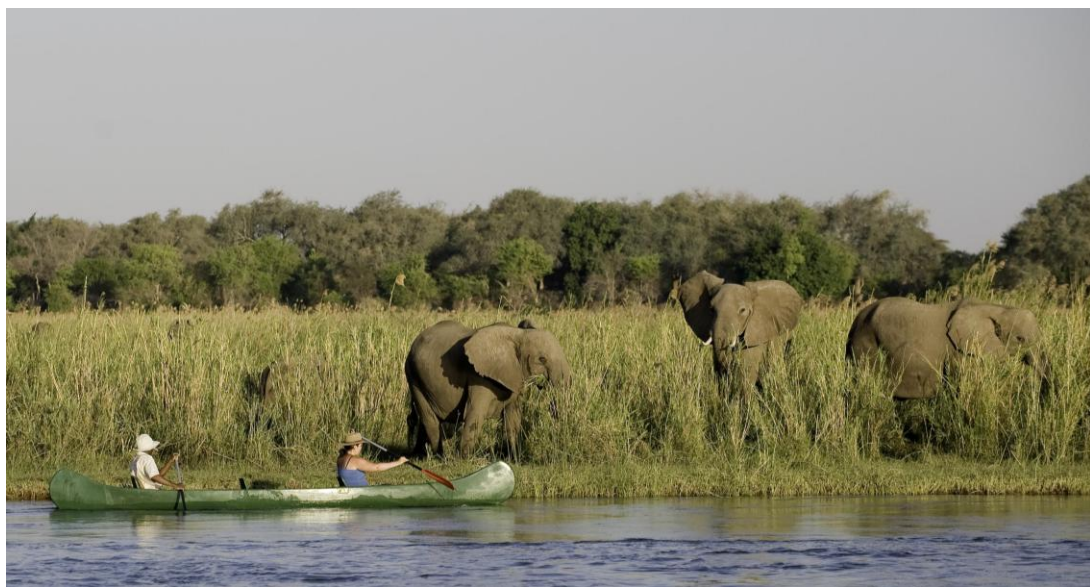

















THANK YOU



WILDERNESS