



WILDERNESS

Kulala Desert Lodge



UNIQUE SELLING POINTS

Kulala Desert Lodge

- Borders the Namib-Naukluft National Park, accessible through an exclusive-use gate, closest to the iconic red dunes of Sossusvlei and Dead Vlei.
- Thrilling hot air balloon flights over the vast Namib Sand Sea and mystical fairy circles launched from our private reserve.
- Set on 27,000 hectares of pristine private land bordering Sossusvlei, the Kulala Wilderness Reserve offers endless spectacular desert scenery and extraordinary and unexpected desert wildlife.
- Adventures exclusive to Wilderness guests within the private reserve include guided nature drives, electric fat bike excursions, hikes and nature trails by day. By night, walks reveal fascinating nocturnal activity, while the spectacular night skies offer the best in star gazing.



WILDERNESS

About Kulala Desert Lodge



23 rooms
(2 family)



Hybrid System



Hot-air ballooning
(extra cost)



Guided nature
walks



Nature
drives



Electric fatbike
cycling



KULALA DEERT LODGE PURPOSE

Transformation into wilderness

Once farmland used for subsistence goat farming, the Kulala Wilderness Reserve had very little indigenous wildlife. In 1996 Wilderness stepped in to rehabilitate the area and today the land and its wildlife have returned to their former glorious natural state.

ACCOMMODATION

Perfect for families

- Comprising 21 units (including two family units), Kulala Desert Lodge is a convivial camp well suited to groups, families and self-drive guests.
- Each canvas and thatch room has a flat rooftop, ideal for sleep-outs under the extraordinary night sky.



Units: 1 - 23

Family Units: 9A - 9B

Family Units: 18A - 18B

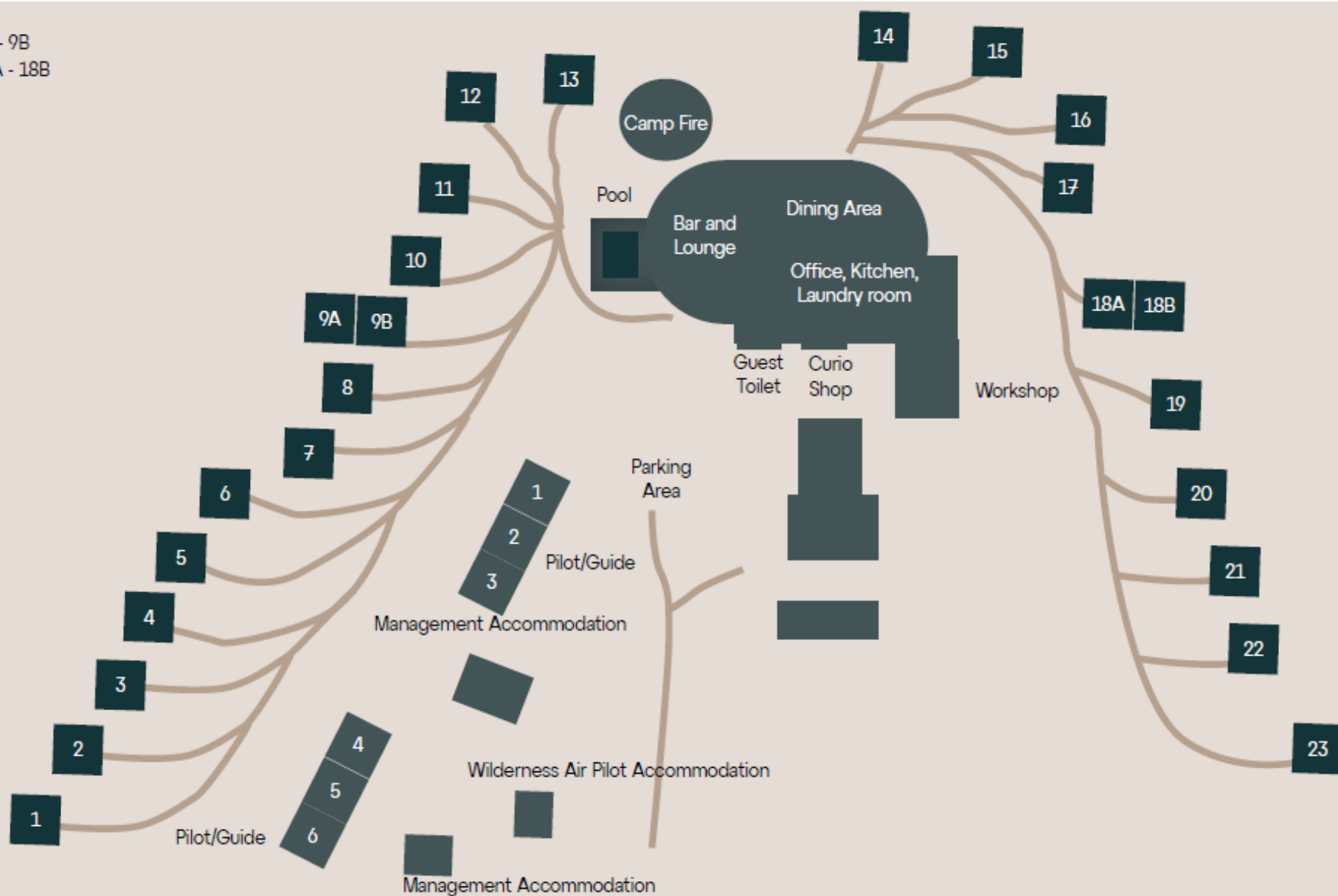

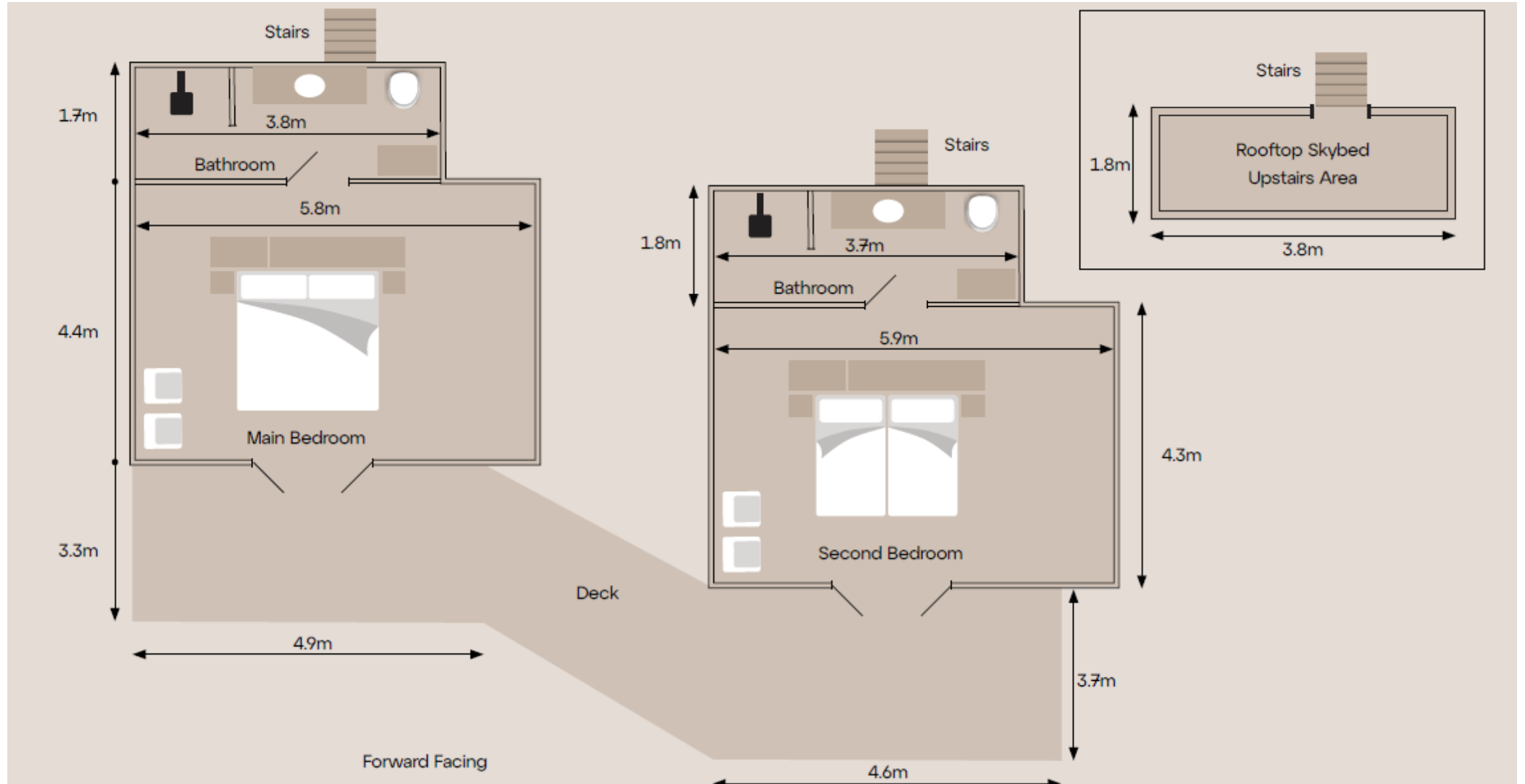

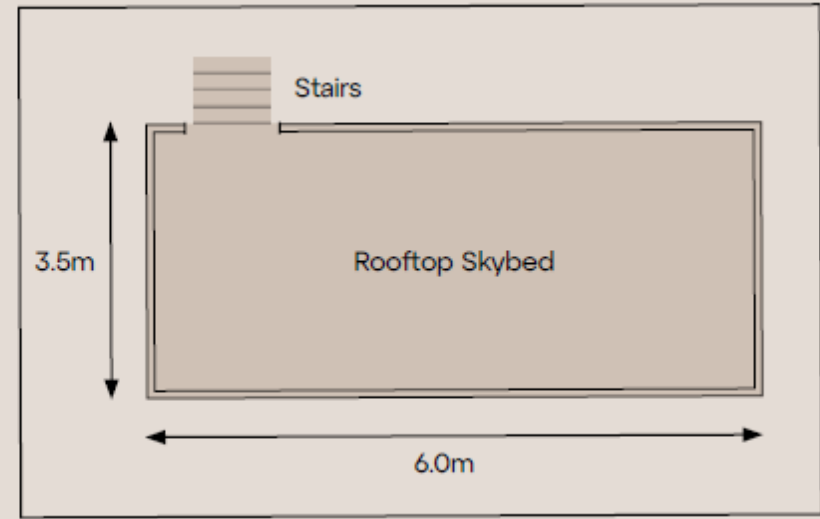
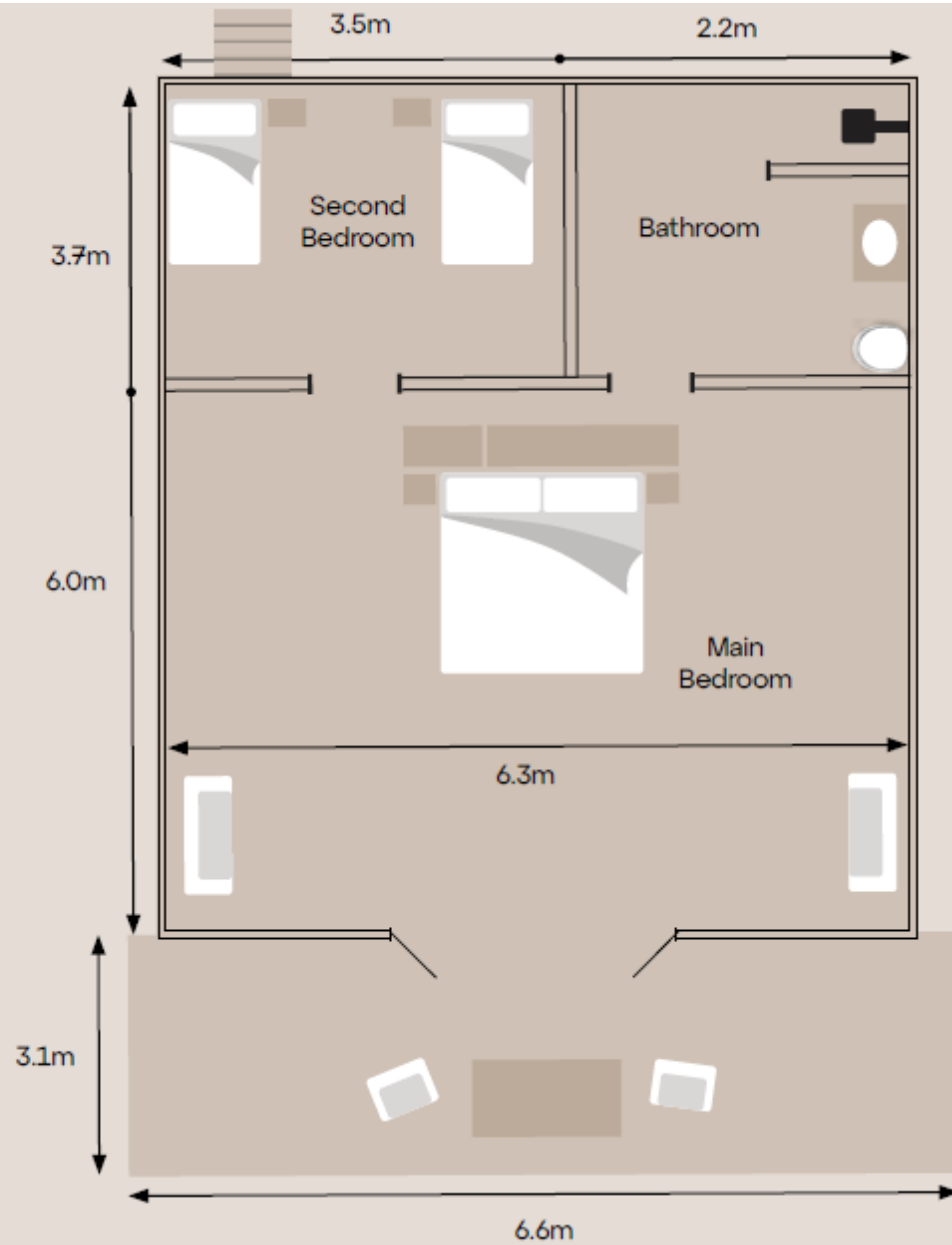

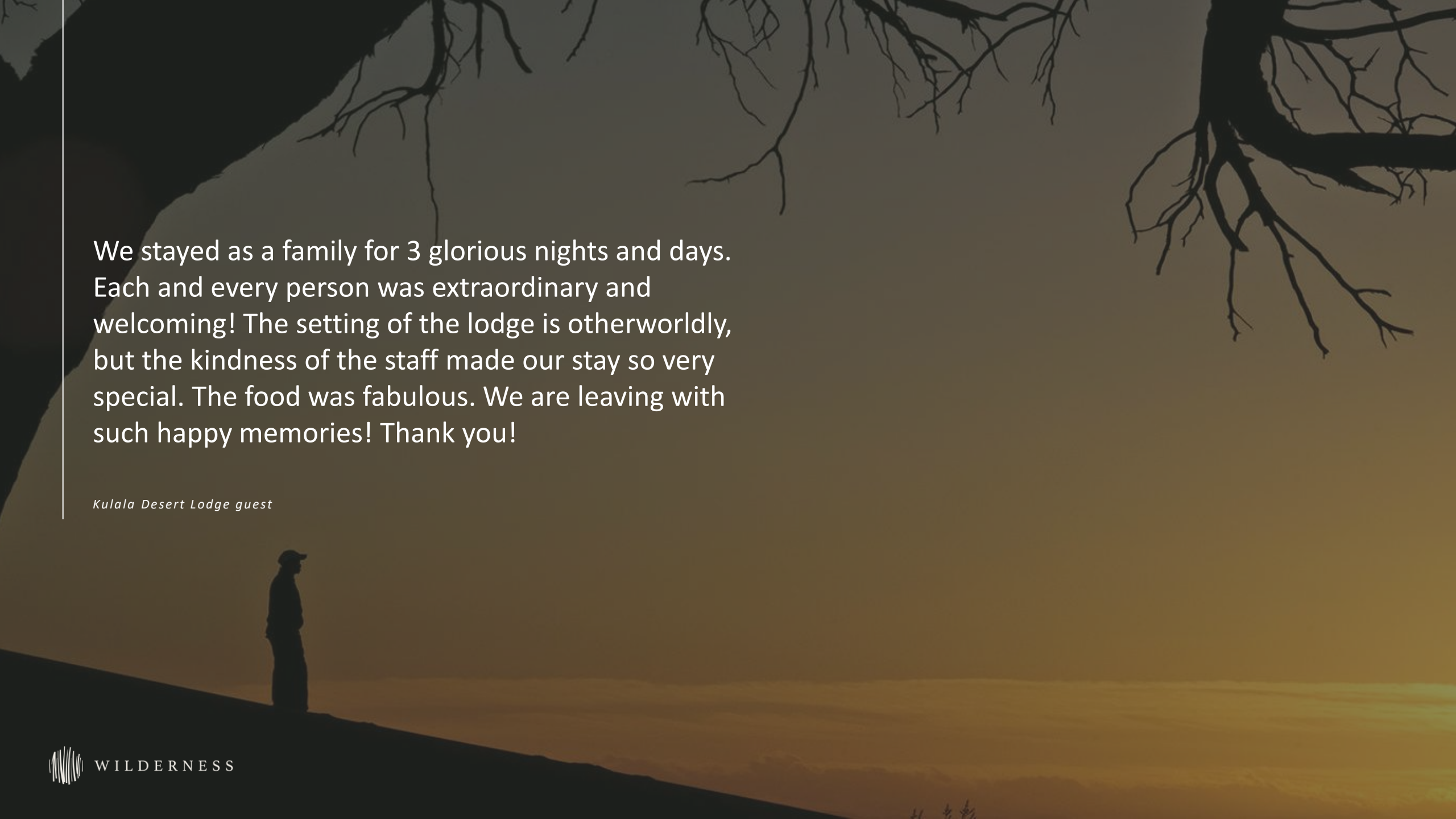
A person stands in silhouette on a dark, sloping hill in the foreground, looking out over a vast, hazy landscape under a warm, golden sunset sky. In the upper portion of the image, the dark, intricate silhouettes of tree branches hang down from the top edge.

We stayed as a family for 3 glorious nights and days. Each and every person was extraordinary and welcoming! The setting of the lodge is otherworldly, but the kindness of the staff made our stay so very special. The food was fabulous. We are leaving with such happy memories! Thank you!

Kulala Desert Lodge guest



WILDERNESS











STARGAZING



SLEEPOUT DECK



BEDROOM AND BATHROOM



ROOM EXTERIOR

THANK YOU



WILDERNESS