



Family Time at Wilderness Safaris



If you are looking for a family-friendly safari, look no further than Wilderness Safaris. In today's busy world, we believe that time out with your family is precious and we are committed to creating a memorable stay for young and old alike.

The beauty of our "family friendly" camps is that guests are able to spend quality time with their children as well as take time to pursue their own interests and relax while in camp. At many of our camps, we have family rooms so that parents can sleep near their children without being cramped in one room. We also have dedicated staff who provide insightful entertainment and special activities just for children.



Breaking News!

Exciting news at Wilderness Safaris is that we have revised our Child Travel Policy in order to make family travel more affordable and infinitely more flexible. In a nutshell:

- 35% discount in peak season and a 65% discount in off-peak season
- This reduced child rate can also be extended up to and including age 16, if sharing with an adult

Each camp offers different activities suited to its own particular environment. For example water activities characterise the wetter regions in the Okavango, while land activities mostly take place around our camps in Namibia. Children can also take part in various arts and crafts, often geared towards acquiring particular traditional skills or building models of animals/local villages, subtly giving your children the opportunity to learn about the local culture and customs while having fun. At night some of the camps even offer elementary stargazing. You can rest assured that your children are in safe hands with our well-trained, friendly and enthusiastic staff.



Seba Camp - a prime example

Our family friendly camps in Botswana accommodate children 6 years and older. Located in Botswana's Okavango Delta, Seba Camp in particular has been specifically designed with families in mind. The décor of the camp as a whole is bright and fun, the interiors created to give extra space for games and energising events – from building sand volcanoes to a football game with the staff!

- Each family unit here is individually designed with different configurations so that you can choose which one is best suited to the size of your family – one with two adjoining bedrooms for families of up to six and the other with a beautiful second-storey viewing deck and lounge.
- Each family suite has its own private swimming pool so that you can relax on the veranda or in your room while the kids splash about in the pool – along with lots of water toys – without having to go to the main pool.
- Entertaining activities led by guides – adults can join in too – subtly encourage children to learn about and fall in love with the wildlife and natural environment around them. For example, elemental photography or catch-and-release fishing might catch the attention of older children, while younger guests can paint with natural bush powder-paints or make a scrapbook.

- Babysitters are available so that parents can enjoy dinner and relax knowing their kids are in good hands.
- Flexibility in activities to allow for early meals for younger children, with the menu itself geared to all ages.
- After dinner, there is the opportunity for the children to sit by the fire and listen to traditional Botswana stories or, if they are feeling a bit restless, they can learn how to dance like the locals – make sure you have your camera ready!

Whatever the age and personal tastes of the children, the kaleidoscopic spectrum of activities on offer is guaranteed to ensure the safari is enjoyed by all. From the safe yet flexible accommodation to our expert child-friendly guides, the only worry is the nagging the parents might get on the flight home about when they can return!

From Seba Camp there are more family friendly Wilderness camps that can be added to your itinerary. For example, DumaTau Camp in the Linyanti – where you can enjoy boating, game drives and various fun activities for the whole family, all with knowledgeable, enthusiastic guides – as well as Kalahari Plains Camp in the Central Kalahari, where you and your family are introduced to the fascinating San bushman people and the amazing wildlife of the desert.



Namibia is another destination ideal for family travel – read more about a recent [trip taken by a staff member and her family](#) to Kulala Desert Lodge in the Sossusvlei region.



Terms and Conditions

In all countries, key criteria apply:

- Private vehicles must be booked for all bookings with children up to and including 12 years of age at our Classic and Premier camps
- Child rates are only applicable when booked into a family room.

Family Room Styles

There are several styles of family room within the Wilderness Safaris group – some with shared facilities and others with separate bathrooms plus additional features. The examples below give you an idea of the differences in layout of these family rooms. Please ask your journey specialist if you need to know more about the family rooms when making an enquiry.

Seba Camp Family Unit

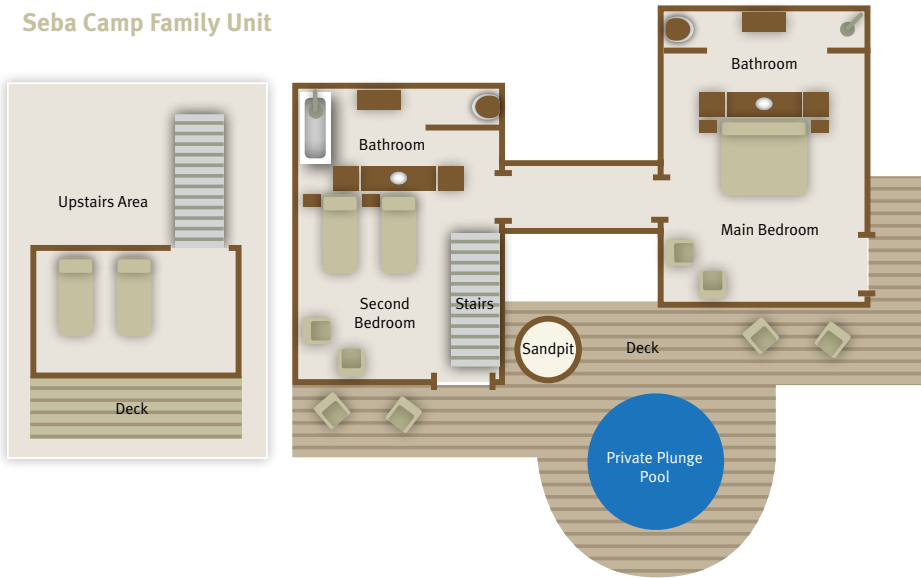

Jacana Camp Family Unit



Kalahari Plains Camp Family Unit

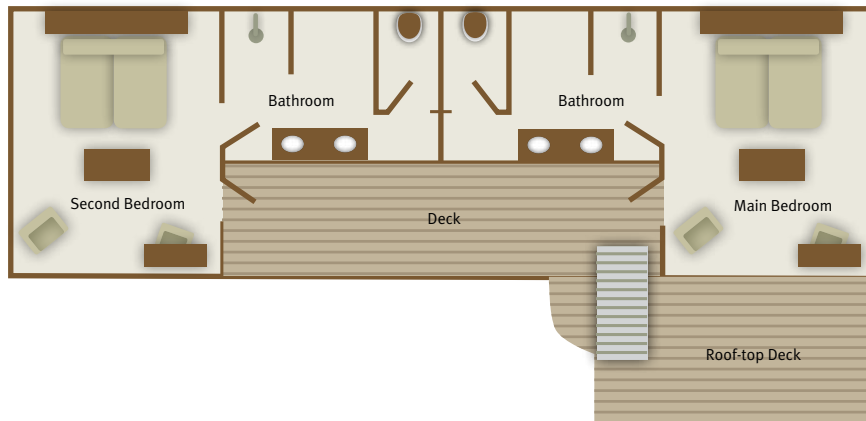

Kulala Desert Lodge Family Room

